

ARCHITECTURAL CEILINGS

BAFFLE SYNCRO UP



Baffle Syncro up

METAL BAFFLE

Picture: "Baffle Syncro up" metal ceiling

BAFFLE SYNCRO UP

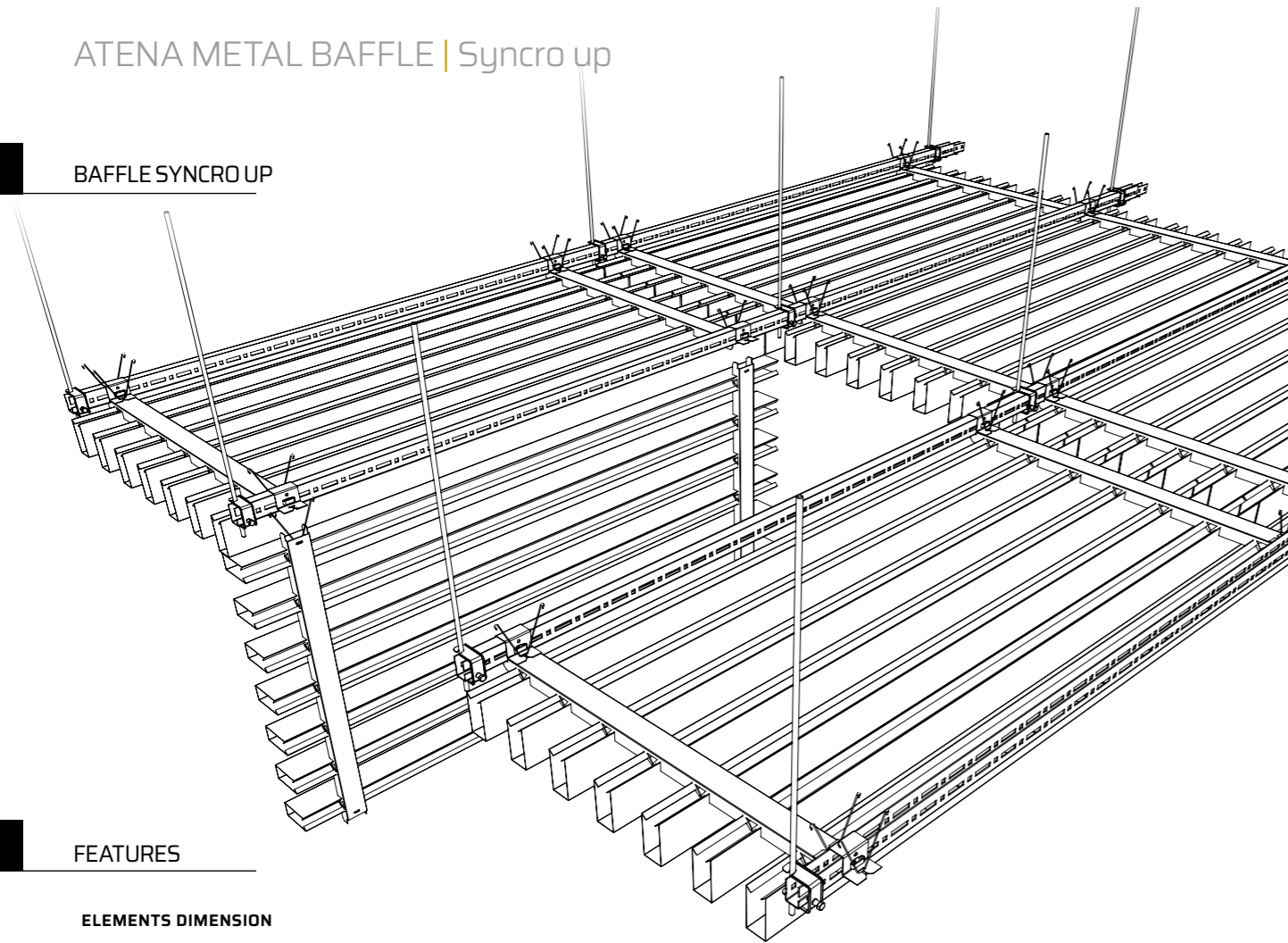

FEATURES

ELEMENTS DIMENSION

20 x 60	TS-Up 20/25
25 x 50	carrier
30 x 64 100	TS-Up 30/40/50
40 x 100	carrier
50 x 100	

Maximum Baffle length 2000 mm

MATERIALS

5/10 aluminium and steel for Baffles base 20 h 60
7/10 aluminium and steel for Baffles base 25/30/40/50

STRUCTURE

Syncro Up carriers in 8/10 black prepainted steel fixed to "U" profiles in 15/10 galvanized steel through Syncro up brackets, springs and fixing clips

ANTISEISMIC EQUIPMENTS

Atena antiseismic kits compulsory for buildings in 3 and 4 Class (NTC 2018 - § 7.2.3)

HANGERS

Threaded bar

BAFFLE COLORS

Atena White | Atena Silver
RAL / NCS coating
Wood effects
Sublimation of images and effects

PERFORATION

To choose among Atena perforation range

ACCESSORIES

Smooth closing caps on request, "U" profile joints

SOUND ABSORBERS

Black acoustic tissue
Standard A1s2d0 | Plus A1
Black Ecofiber Bs2d0
Enveloped mineral fiber B2

Components

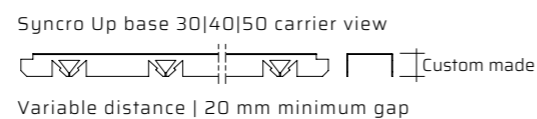
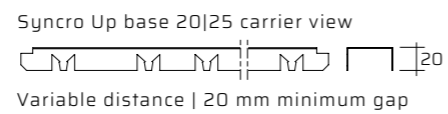
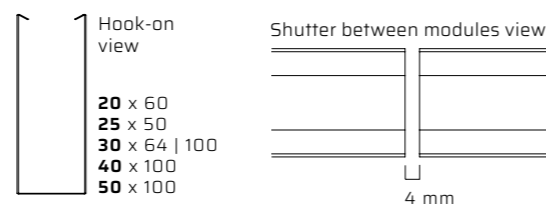

Easy installation steps

Syncro - up carrier "double face" mode to install "U" profile at the right distance

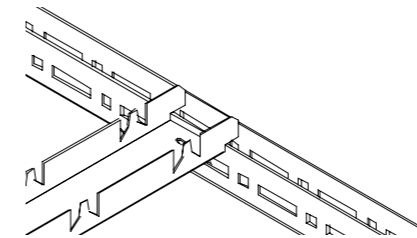
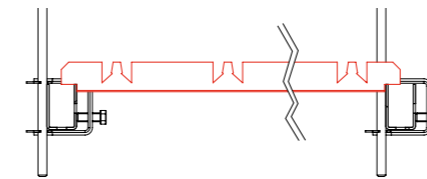

1. Hanging system.
2. Special Syncro up carrier with dual function, as template to install "U" profile at right interaxe, as baffle carrier to create the baffle modules.
3. Syncro up brackets to with locking clip to install Baffle modules and secure the installation.
4. Syncro up modules.

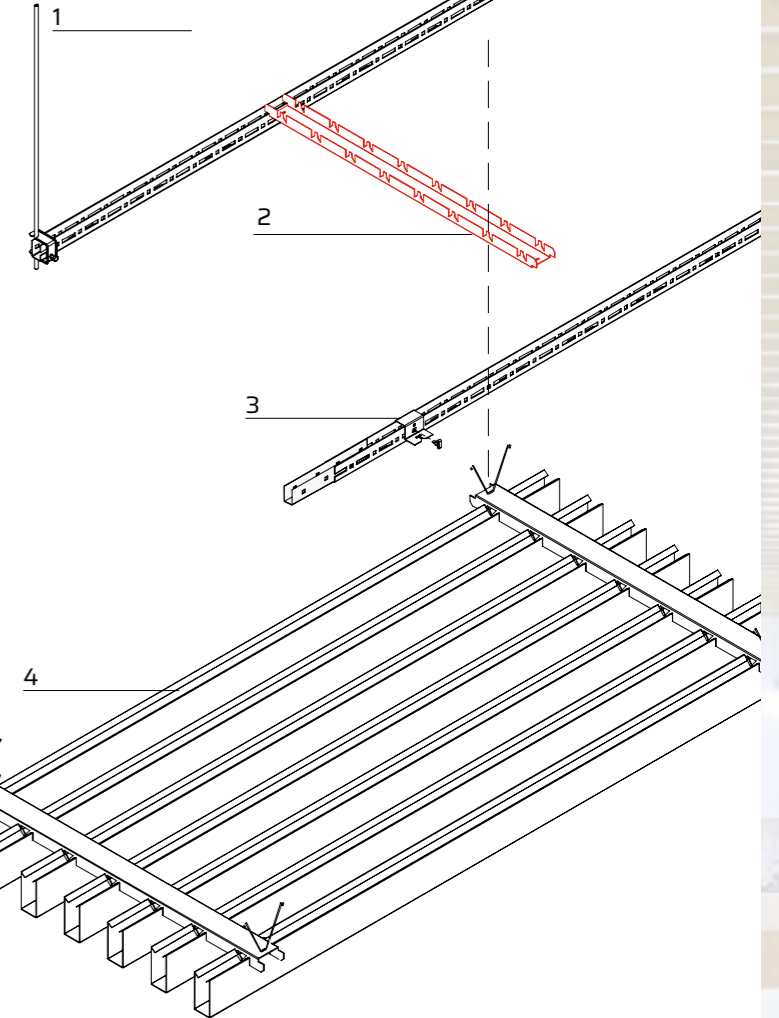

System detail

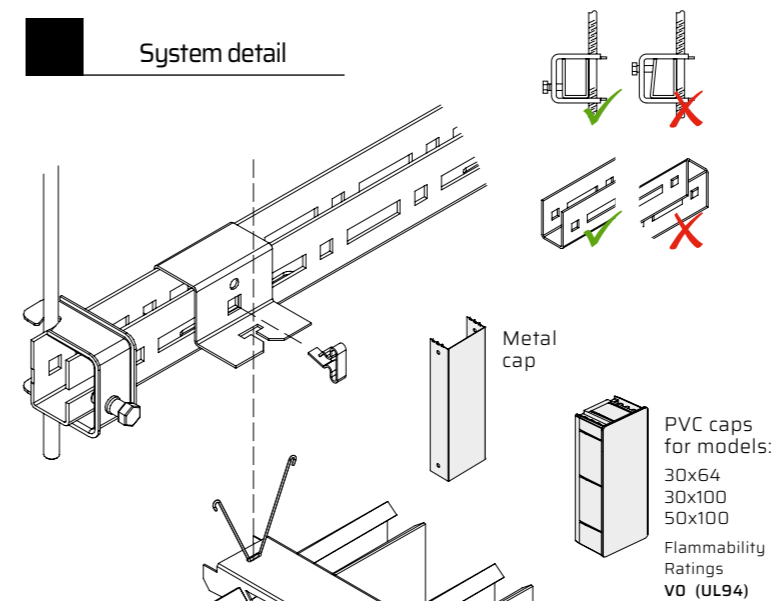

SPECIAL FINISHING

- Metal wood effect
- PVC covering
- Nanotech powder coatings
- Sublimations
- Digital printing

The **aesthetic metal finishing** represents an important phase of the manufacturing process, and includes a wide range of **decorative techniques**, high levels of **precision in execution**, continuous research of **new materials** and **latest generation machines** to ensure high quality standards.

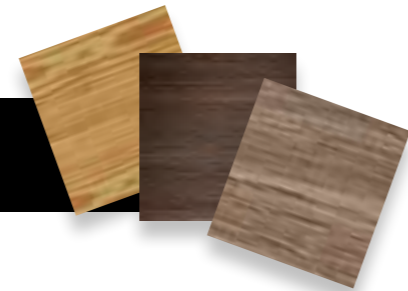

Standard aluminum wood



L07 MEDIUM PINE L13 CHENE IRLANDAIS



L17 OREGON 4 L14 MADERA BRAZIL

Standard steel wood



L04 LIGHT MAPLE L05 MEDIUM DURMAST L06 DARK WALNUT

Sublimation



S14 CONCRETE S15 CORTEN S16 CROCODILE



S07 BLUE PRINCESS S01 TAPESTRY S13 ALBA

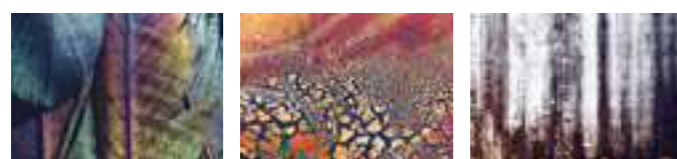

S08 RAINBOW PLUME S03 CALEIDO S11 LOUNGE



PERFORATION SET

PARALLEL PERFORATIONS

Ø = 0,75 ≤ 1,5 mm

AP 0,75 / 2% P

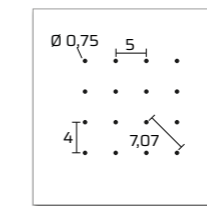

AP 1,5 / 11% P

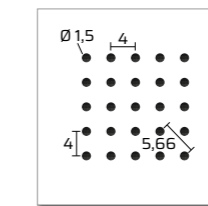

AP 1,5 / 22% D

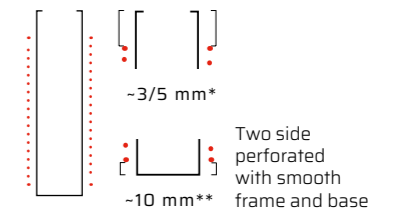
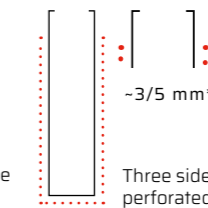
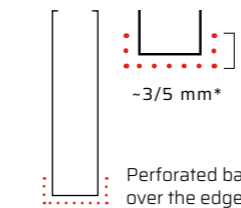
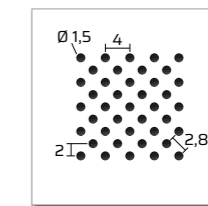

PARALLEL PERFORATIONS

Ø = 1,8 ≤ 2 mm

AP 1,8 / 9,5% P

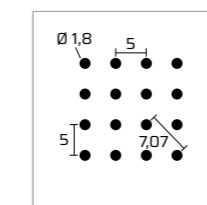

AP 2 / 12,5% P

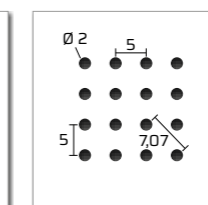

AP 1,8 / 19% D

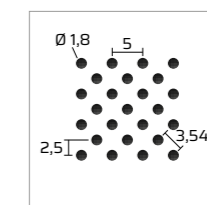

AP 2 / 25% D

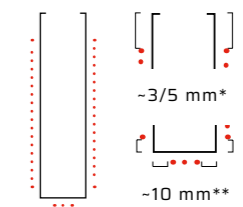
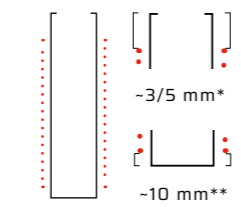
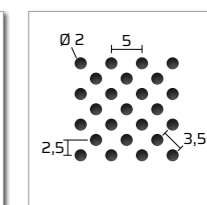

Perforations legend

•••• Perforated area

* According to holes interaxe;

** According to holes interaxe; not available for base 30 mm

Schedule: thickness of drillable steel-aluminum
NA= Not available
CW= Maximum coil length
PW= Maximum perf. width
6/10 for 30x100 | 50x100 only.

PERFORATIONS	0,5	0,6	0,7	CL	PW
AP 0,75/2% P	•	•	NA	1000	850
AP 1,5/11% P	•	•	•	1300	1300
AP 1,8/9,5% P	•	•	•	900	800
AP 2/12,5% P	•	•	•	1250	1200
AP 1,5/22% D	•	•	•	1300	1300
AP 1,8/19% D	•	•	•	900	800
AP 2/25% D	•	•	•	1250	1200